

PLAN	SURVEYED	DATE
	PLOTTED	
	CHECKED	
	ALLOWED	
	PAID FILE NAME	
	NO.	

PROFILE	SURVEYED	DATE
	PLOTTED	
	CHECKED	
	NOTATIS CHKD	
	NO.	

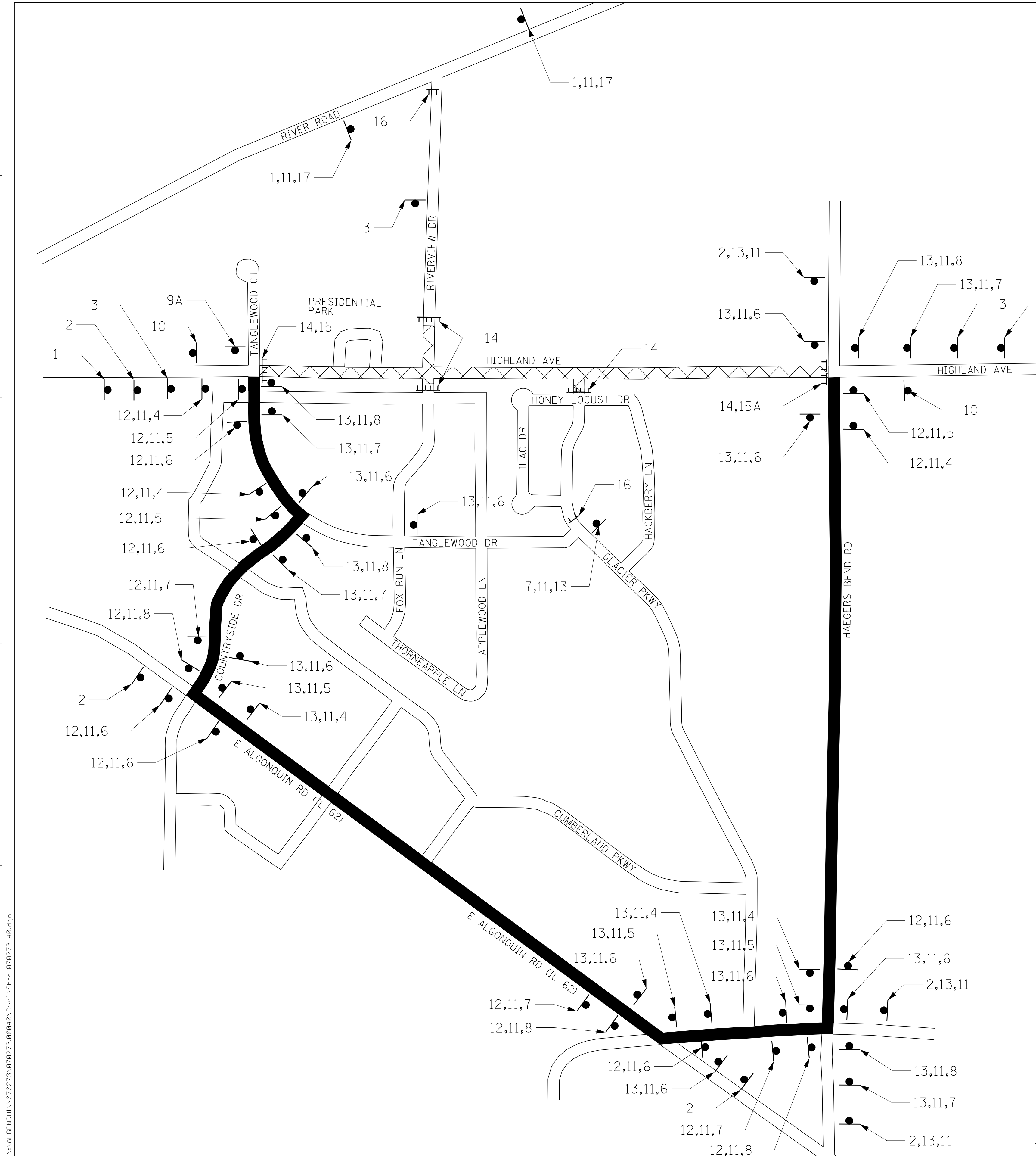

SIGN LEGEND

	1. ADVANCE DETOUR SIGNS W20-3 48"x48" WITH AMBER FLASHING LIGHT		9. NO RIGHT TURN R3-1 30"x30"
	2. ADVANCE DETOUR SIGNS W20-2 48"x48" WITH AMBER FLASHING LIGHT		9A. NO LEFT TURN R3-2 30"x30"
	3. ADVANCE DETOUR SIGNS W20-3 48"x48"		10. END DETOUR SIGN M4-3A 21"x15"
	4. DETOUR ARROW SIGN M4-9 30"x24"	Highland Ave	11. ROAD NAME SIGN, 48"x18" 8" UC LETTERS, 6" LC LETTERS
	5. DETOUR ARROW SIGN M4-9 30"x24"	EAST	12. EAST ASSEMBLY SIGN M3-2(O) 24"x12"
	6. DETOUR ARROW SIGN M4-9 30"x24"	WEST	13. WEST ASSEMBLY SIGN M3-4(O) 24"x12"
	7. DETOUR ARROW SIGN M4-9 30"x24"		14. R11-2 48"x30", MOUNTED ABOVE TY III BARRICADE
	8. DETOUR ARROW SIGN M4-9 30"x24"		15. M4-10R 48"x18", MOUNTED ABOVE TY III BARRICADE
			15A. M4-10L 48"x18", MOUNTED ABOVE TY III BARRICADE
	DETOUR ROUTE		16. R11-4 48"x30", MOUNTED ABOVE TY III BARRICADE
	COMPLETELY CLOSED SECTION OF HIGHLAND AVENUE	Use River Road	17. ROAD NAME SIGN, 48"x18" 8" UC LETTERS, 6" LC LETTERS

NOTES:

- ALL DETOUR SIGNING SHALL BE INCLUDED IN THE COST OF TRAFFIC CONTROL AND PROTECTION (SPECIAL).
- THE CONTRACTOR SHALL NOTIFY THE ILLINOIS DEPARTMENT OF TRANSPORTATION ONE MONTH PRIOR TO CLOSURE. DETOUR ROUTES AND ASSOCIATED SIGNAGE WILL NEED TO BE IN PLACE TWO WEEKS PRIOR TO CLOSURE.
- ALL DETOUR SIGN SPACING SHALL BE IN ACCORDANCE WITH IDOT DISTRICT ONE DETAIL TC-21.

SUGGESTED ORDER OF CONSTRUCTION ACTIVITIES:

- CLOSE HIGHLAND AVENUE TO ALL TRAFFIC FROM TANGLEWOOD COURT TO HAEGERS BEND ROAD. SEE DETOUR PLAN ABOVE FOR DETAILS.
- PLACE AND MAINTAIN SEDIMENT AND EROSION CONTROL MEASURES PER THE STORM WATER POLLUTION PREVENTION PLAN AND AS DIRECTED BY THE ENGINEER.
- RECONSTRUCT HIGHLAND AVENUE FROM TANGLEWOOD COURT THROUGH RIVERVIEW DRIVE/FOX RUN LANE BEFORE STARTING ANY CONSTRUCTION ACTIVITIES EAST OF RIVERVIEW DRIVE/FOX RUN LANE, EXCEPT THAT STORM SEWERS P302 AND P304 SHALL BE CONSTRUCTED AT THIS TIME IN ORDER TO MAINTAIN DRAINAGE.
- AFTER STEPS 1-3 ARE COMPLETE, OPEN HIGHLAND AVENUE TO TWO-WAY TRAFFIC FROM TANGLEWOOD COURT TO RIVERVIEW DRIVE/FOX RUN LANE. RELOCATE THE TYPE III BARRICADES FROM THE EAST LEG TO THE WEST LEG OF THE TANGLEWOOD COURT INTERSECTION. REMOVE THE TYPE III BARRICADES FROM THE NORTH AND SOUTH LEGS OF THE RIVERVIEW DRIVE/FOX RUN LANE INTERSECTION. MAINTAIN THE REST OF THE DETOUR PLAN AND SIGNAGE AS SHOWN ABOVE.
- RECONSTRUCT HIGHLAND AVENUE FROM EAST OF FOX RUN LANE TO STATION 44+56.
- THE RECONSTRUCTION PORTION OF THE PROJECT MUST BE FINISHED BEFORE THE RESURFACING PORTION MAY BEGIN. CONSTRUCTION TRUCKS AND TRAFFIC MUST USE EXISTING PAVEMENT WITHIN THE RESURFACING PROJECT LIMITS. THIS WORK WILL BE PAID FOR AS "TEMPORARY ACCESS (ROAD)" AND "TEMPORARY ACCESS (PRIVATE ENTRANCE)".